



4/15-19 Ellis Street Condell Park NSW

5 🛏 2 🚿 2 🚗

WELCOME TO YOUR NEW HOME?.

Modern and spacious five bedroom townhouse, offering the perfect combination of contemporary living and low-maintenance convenience. Whether you're a first home buyer looking for a comfortable family abode or an investor seeking a lucrative opportunity, With its spacious interior, convenient features, and outdoor entertaining options this property has something for everyone.

FEATURES OF THE HOME:

- Quality brick veneer construction and ultra-modern designer finishes
- Five generously sized bedrooms spread across two levels, two with built in wardrobes and two with walk in

[For full version visit the website](https://www.ariarealtyco.com.au)

Type : Townhouse
Price : \$ 950,000
Building Size : 169 sqm
Land Size : 252 sqm
View : <https://www.ariarealtyco.com.au/sale/nsw/canterburybankstown/condell-park/residential/townhouse/7676664>



Laura Raneri
02 9925 9919



Michael Toumas
02 9925 9919

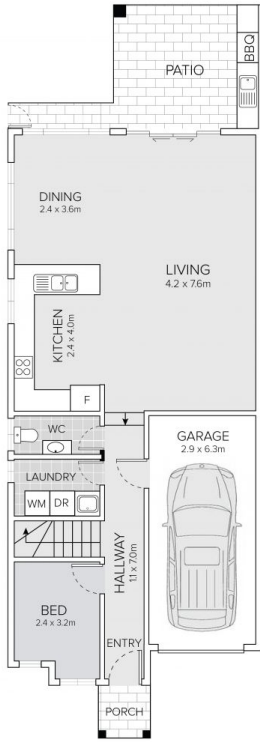

GROUND FLOOR

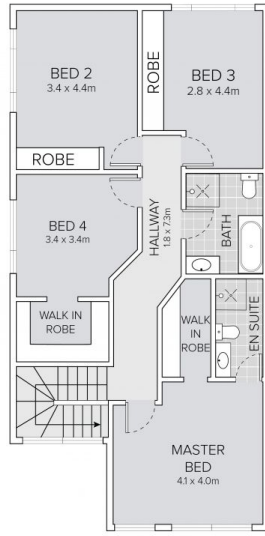

FIRST FLOOR



SITE PLAN

Unit 4/15 Ellis Street, Condell Park

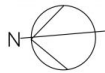

Scale in metres, Indicative only. Dimensions are approximate.
 All information contained here is gathered from sources we believe to be reliable.
 However, we cannot guarantee its accuracy, and interested persons should rely on their enquiries.