

**20 Faulkner Way Edmondson Park NSW**

4 2 4

WELCOME TO YOUR NEW HOME?.

Double storey, brick veneer beauty is the epitome of modern living. Elegantly designed with a turn-key finish, this home seamlessly blends luxurious features with a practical layout. From the modern kitchen with stainless steel appliances to the spacious backyard oasis, this turnkey property is ready to be your dream home.

#### FEATURES OF THE HOME:

- Double-storey brick veneer construction exudes elegance and durability.
- Four spacious bedrooms, each equipped with built-in wardrobes and lush carpeting, offer cozy retreats

[For full version visit the website](https://www.ariarealtyco.com.au)

**Type** : House  
**Price** : \$ 1,235,000  
**Land Size** : 330 sqm  
**View** : <https://www.ariarealtyco.com.au/sale/nsw/liv-erpool-fairfield/edmondson-park/residential/house/7812887>



**Ali Abouloukme**  
02 9025 9948



**Ansar Ali Jaferi**  
02 9025 9948

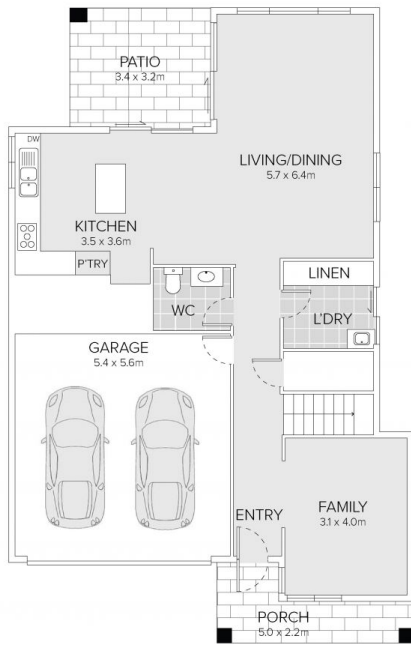

GROUND FLOOR

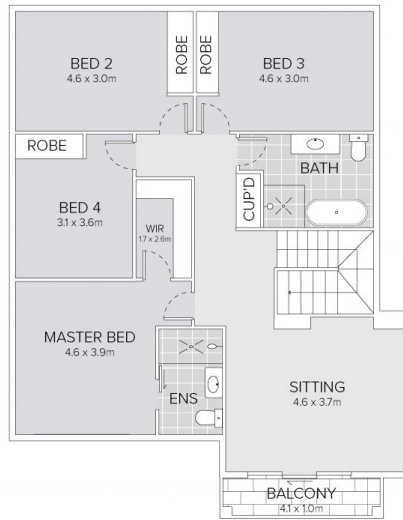

FIRST FLOOR

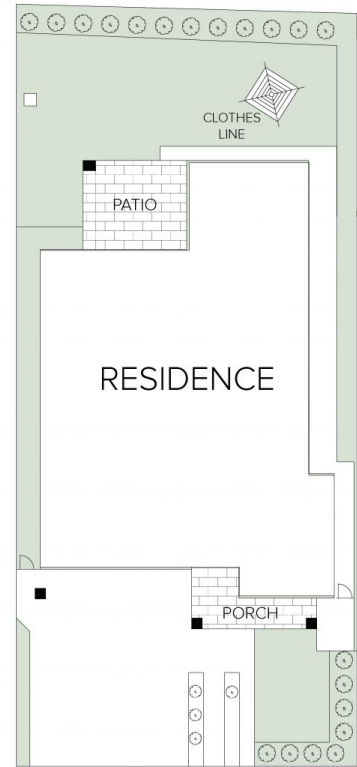

SITE PLAN



## 20 FAULKNER WAY, EDMONDSON PARK

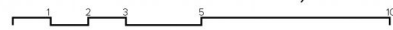

Scale in metres, Indicative only. Dimensions are approximate.  
 All information contained here is gathered from sources we believe to be reliable.  
 However, we cannot guarantee its accuracy, and interested persons should rely on their enquiries.