

2/49 Lachlan Street Warwick Farm NSW

2 2 1

WELCOME TO YOUR NEW PROPERTY?

This secure and contemporary ground floor apartment offers a two bedroom harmonious blend of style and functionality. This meticulously designed apartment offers an ideal blend of modern aesthetics and practicality. Whether you're a first-time buyer looking for a cozy home or an investor seeking a lucrative opportunity, this property caters to your every need.

FEATURES OF THE PROPERTY:

- Two bedrooms with built-in wardrobes provide ample storage and a cozy retreat for relaxation
- Master Bedroom complete with a stylish ensuite and a

[For full version visit the website](https://www.ariarealtyco.com.au)

Type : Unit
Price : \$ 520,000
Building Size : 102 sqm
Land Size : 156 sqm
View : <https://www.ariarealtyco.com.au/sale/nsw/liverpool-fairfield/warwick-farm/residential/unit/7890924>



Laura Raneri
02 9925 9948



Kyrollos Keriakos
02 9925 9948

<https://www.ariarealtyco.com.au>

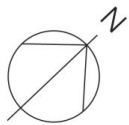
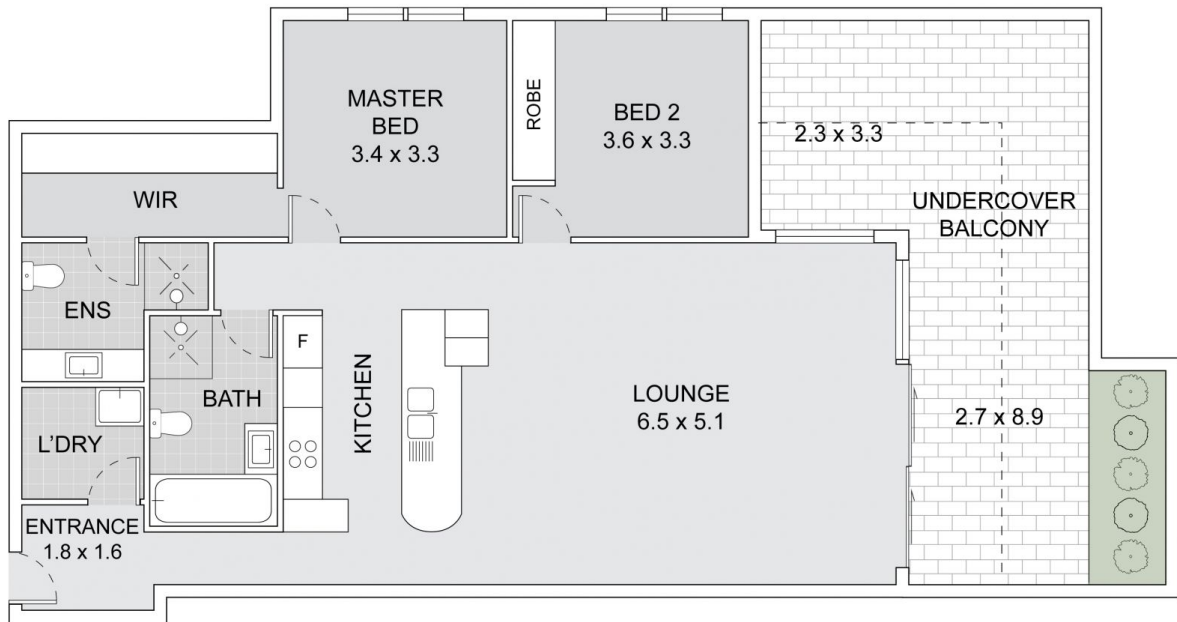

2/49 Lachlan Street, Warwick Farm

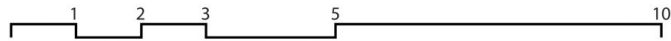

Scale in metres. Indicative only. Dimensions are approximate.

All information contained here in is gathered from sources we believe to be reliable.

However we cannot guarantee its accuracy and interested persons should rely on their own enquires.